

# Fences

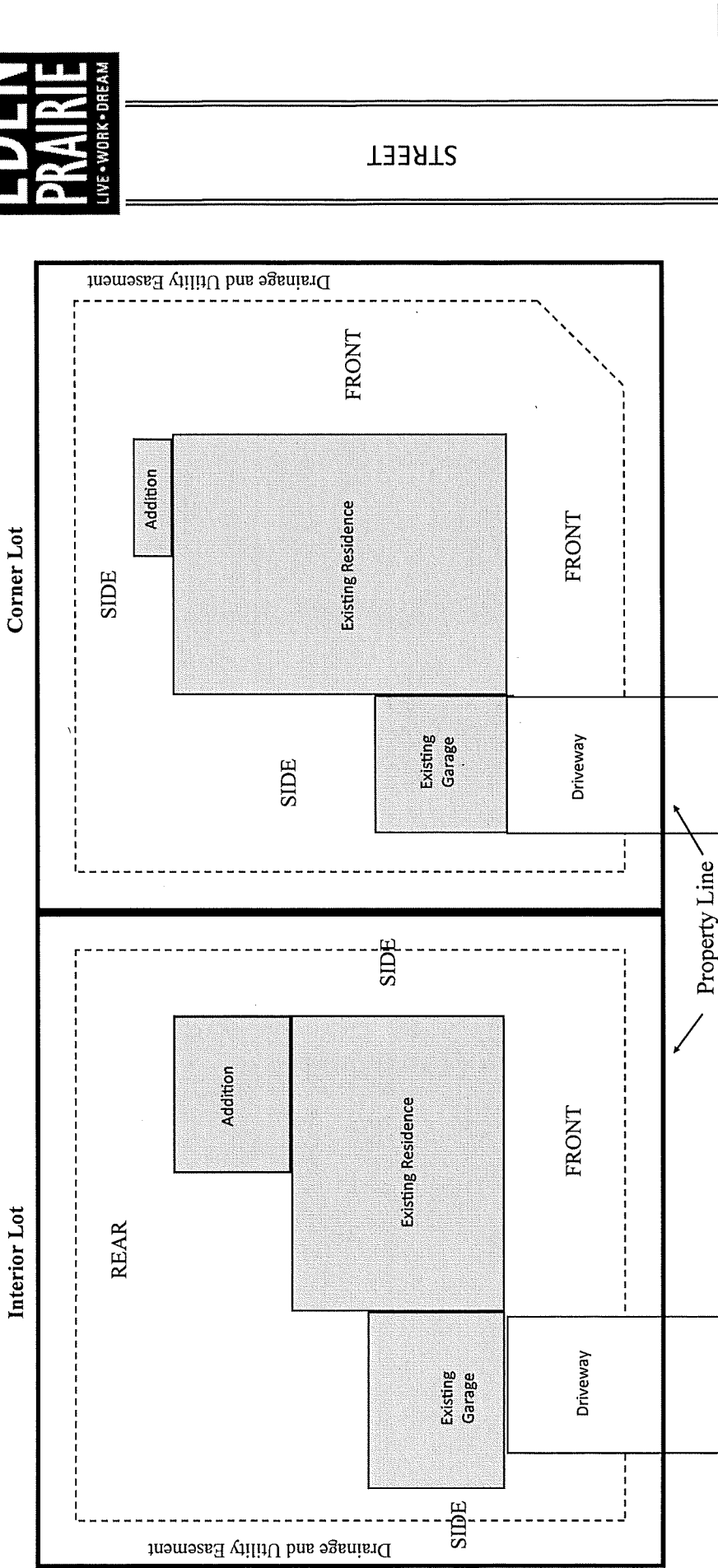

8080 Mitchell Road, Eden Prairie, MN 55344 Phone: 952-949-8485 Fax: 952-949-8392  
 Website: <http://www.edenprairie.org>



----- Recommended Location for Fences

STREET

No permits are required for construction of fences. Maximum height for a fence is 7 feet. Fences may be located up to the property line, however; it is recommended that the fence be placed outside the drainage and utility easement in order to allow installation, repairs, and maintenance without entering neighboring properties. Additionally, should the City or a public service utility have to enter the drainage and utility easement the City or service utility are not responsible for replacement of the fence. If a fence will be located on a corner lot that abuts an intersection or Public Right-of-Way, it is necessary to contact Randy Newton in the Engineering Department at 952-949-8339 in order to request a sight line distance review to ensure adequate visibility. The fence may be required to be setback to not block pedestrian or vehicular views at an intersection. It is suggested to have a copy of the property survey prior to fence installation to indicate the exact location of the lot lines. The curb is not the property line. The city has no architectural control standards for fences; however, private covenants and restrictions through a home owner's association may prohibit fences or indicate some architectural controls. Check with your homeowner's association. Call Gopher State One at (651) 454-0002 before you dig!